

Instructions for Use of Lydsto Handheld Dust Collector and Emergency Power Supply

Notes

Read these Instructions carefully before use and properly keep these Instructions. The machine body will become hot after long use. Use again after they are cooled. Remember to clean the dust box after dust collection to prevent product damage. Do not allow children to use this product as it is not a toy.

Product Introduction

- ① Battery capacity indicator
- ② 00 interface
- ③ Battery wake-up
- ④ 18W fast charge output
- ⑤ Charging interface
- ⑥ Collector level switch button
- ⑦ Dust box cover flipping button
- ⑧ Suction nozzle
- ⑨ Dust cover
- ⑩ Dust box

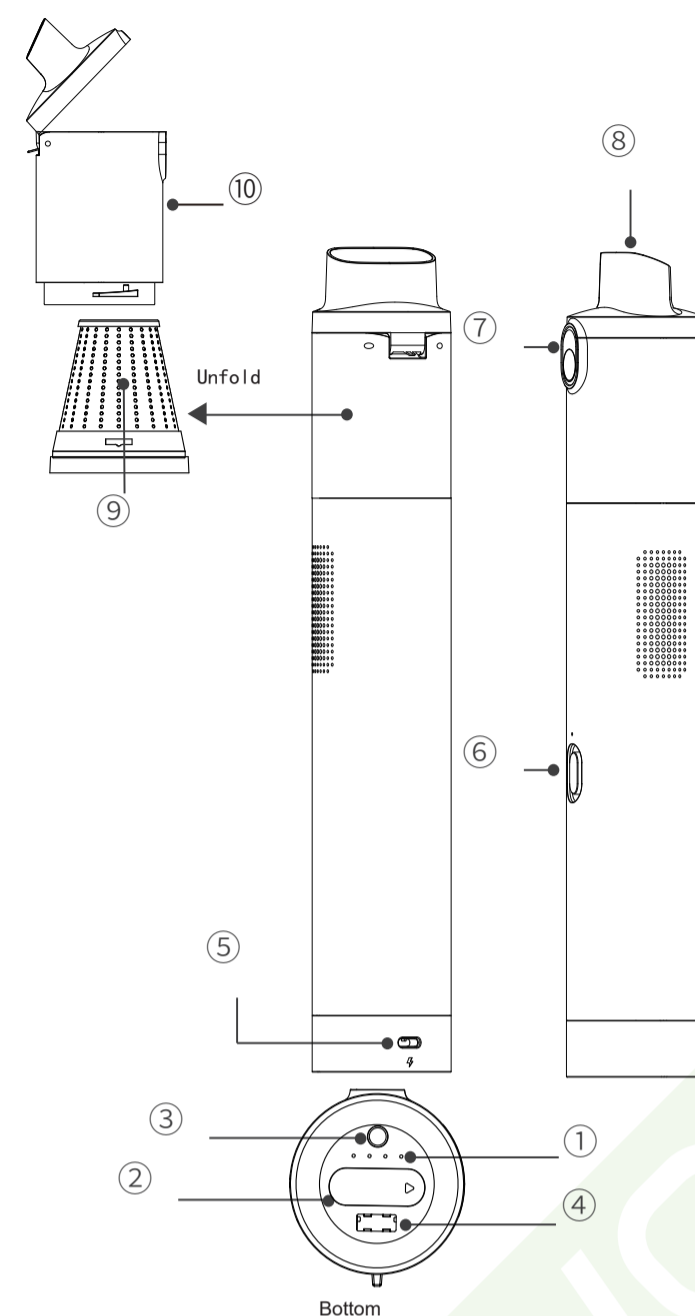

List of Accessories

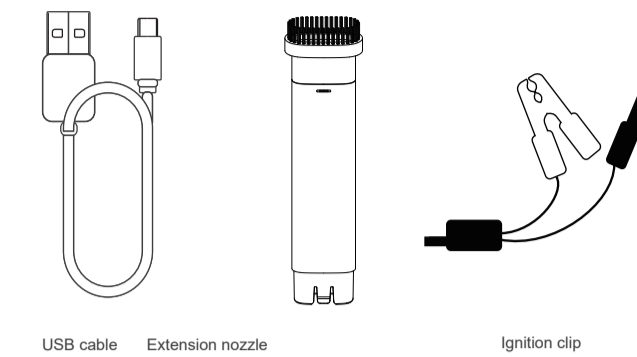

User Guide

一、 Battery capacity display, charging and discharge

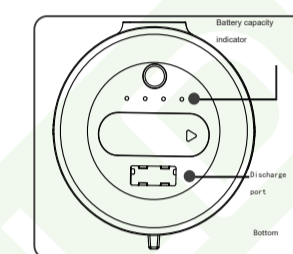

4 LED power indicator. Respectively represent 25%/50%/75%/100% power state. The corresponding battery capacity indicator flashes during charging. The discharge port is port A, which can be used to charge mobile devices.

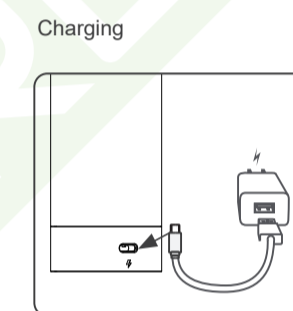

Fully charge the battery before first use. Connect the USB cable between a 5V USB charger (The charger needs to be purchased by yourself. It is recommended to use a charger with a power of 5V 2A or above to achieve the specified charging speed) and charge with the dust collector and emergency power supply. During charging, the capacity indicator displays the following colors to indicate different states: LED light flashing: charging; 4 LED lights always on: fully charge

二、 How to Use the Accessories

How to Use the Ignition clip

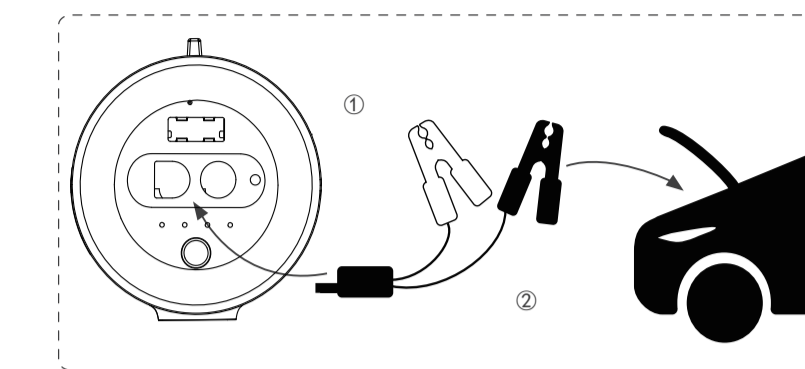

- ① Insert the plug fully into the starting power supply, the green and red indicator lights flash alternately.
- ② Connect the red clamp to the car battery "+" and the black clamp to the car battery "-". The indicator light is always green. After starting the car, remove the clamp from the battery. Note: Users are advised to connect the negative pole of the battery first and then the positive pole.

How to use the extension nozzle

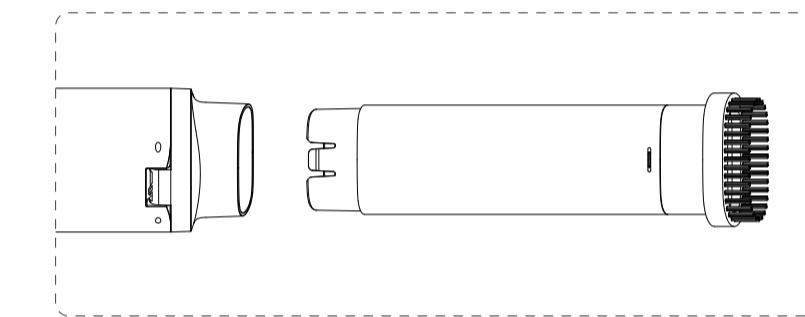

Directly insert the extension nozzle and fix it. Then it can be used.

三、 Dust Collection Start dust collection

- ① The user may select the level and accessories depending on the demands (see Figure 2).
- ② Infiltration or dust collection. Press the button once to automatically start dust collection.

The gear of dust collection can be switched. (Press once to select low level, the white light is always on. Press twice to select high level, the blue light is always on. Press three times, the machine is turned off, and the light goes out.)



图2

四、 Cleaning

Clean the dust box

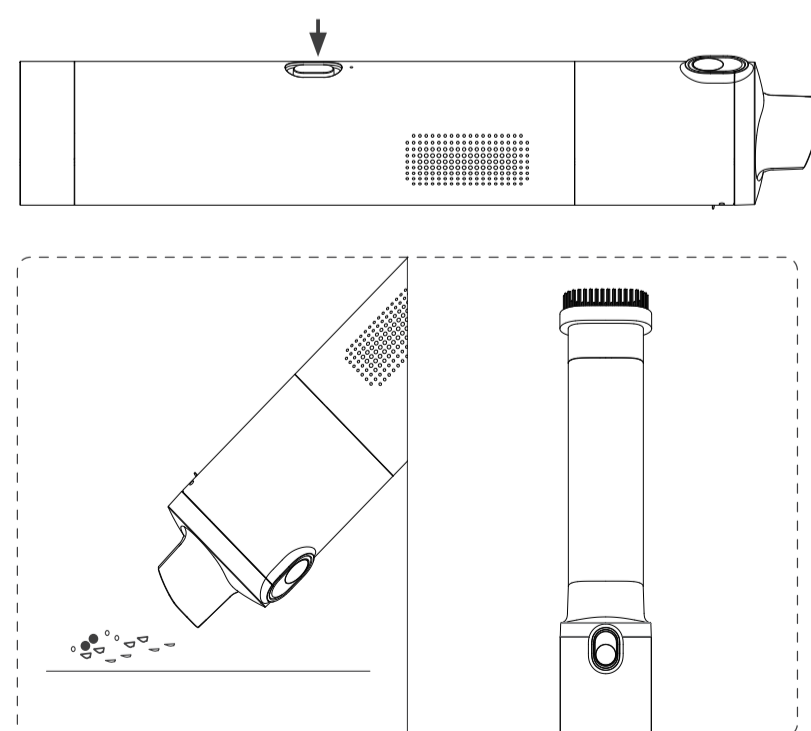
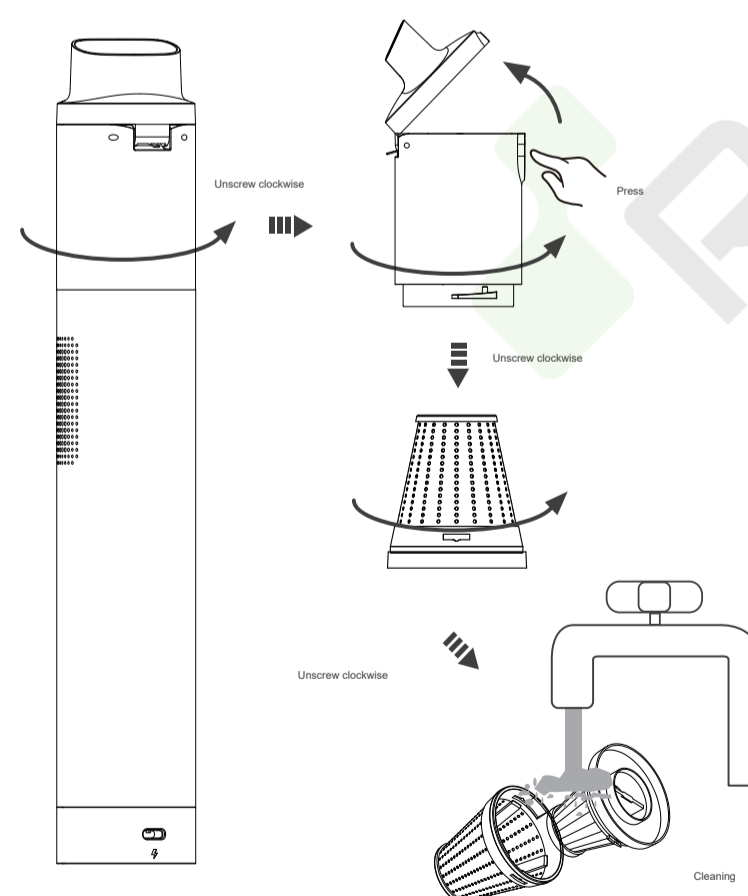

- Notes:
- ① Only the dust box can be cleaned.
 - ② Other parts than the dust box must be kept away from water sources.
 - ③ The dust cover may be used only after dried. Otherwise dust infiltration will be affected.

Technical Parameters

Product name	Lydsto Handheld Dust Collector and Emergency Power Supply
Product model	YM-XCYJDY02
Standard basis	GB4706.1-2005, GB4706.7-2014
Rated voltage	5V
Rated current	2A
Product size	316x55x55mm (size of bare machine, without accessories)
Net weight	560g
Ignition clip	10AWG wire rod support reverse charging protection and reverse connection protection. Do not store this product under any temperature below -40°C.
Operating temperature	-20°C~60°C (support ultra-low temperature discharge)
Charging interface	Type-C
Discharge interface	Type-A
Battery capacity	10000mAh
Time of charging	< 5 hours
Discharge power	18W max
Maximum suction pressure	10KPa

Considerations

1. Before using this product, please read the instructions carefully. This product is not a toy. Do not allow children to use. Users no younger than 16 years old are suggested.
2. This product is integrated with a lithium battery. Do not throw this product into fire or randomly. The lithium battery may ignite, spontaneously combust or explode due to overheat, impact and water penetration. Please avoid exposure to the sun in vehicles and other high temperature environments.
3. or above 60°C. Otherwise, the service life of this product will be shortened and the inner battery will be damaged.
4. The inner battery may be damaged if this product is not used for a long time. It is suggested to charge this product at least every three months.
5. This product is integrated with a DC motor which may generate electric sparks during use. Therefore, do not use this product in flammable and explosive environment.
6. Use this product in a dry and clean environment, because ingress of soil and dust may damage this product. This product is not water proof. Therefore, do not rinse it with water (only the dust box can be washed).
7. The product is used for 12V vehicle start, if it is used for other start, it may be dangerous.
8. After jump-start the car successfully, please remove the product from the car battery within 30s, otherwise it may cause damage.
9. Do not clamp the positive and negative poles to the ignition clip.
10. If you need to ignite multiple repeatedly for special reasons, it is recommended that the interval between each start is more than 2 minutes.
11. Do not place the product in an environment where the temperature exceeds 60°C.

Troubleshooting

Fault	Solution
This product cannot collect or sufficiently collect dust.	1. Check if the battery capacity is sufficient. 2. Check if the suction nozzle is well fixed. 3. Check if the filter screen is clogged.
This product cannot work normally.	Because the equipment voltage is too low, the low-voltage protection function is activated to cut off the circuit.

Manufacturer: Guangdong Yimu Technology Co., Ltd.
Address: Room 201, Building 1, No. 1, Dongsan Lane, Hengjiang, Fushan, Liaobu Town, Dongguan, Guangdong, China
Service Hotline: +86 4000778387

